

# Special High Efficiency Part Washer

## Manual

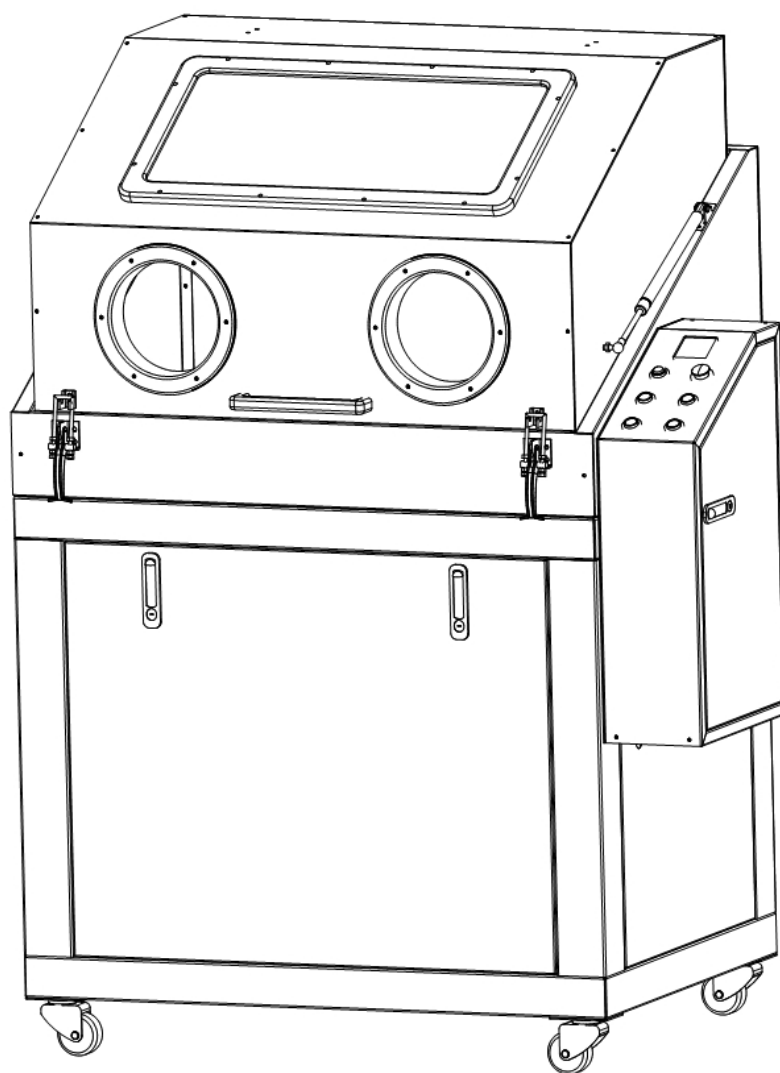

**Yongkang Jinding mechanical Tools Co., Ltd.**

## • **Directory List**

1. Technical specifications
2. Warning
3. Important reminder
4. Installation instructions
5. Operational instructions
6. Explosive drawings and parts list

## • **Technical Specifications**

Quota power: three-phase :380 V50HZ (three-phase 220 V60Hz)

Pump pressure (muzzle pressure):100-150 BAR

Motor: Voltage Three Phase :380 V (Three Phase 220 V60Hz)

W 3000 rated

Speed 1450 rpm

Heater: three-phase 380 V 6000W voltage

Working light :24 V,20W

Dimensions :112\*150.6\*71.5(cm)

Packing Size :157\*115\*80(cm)

Net weight: kg 178

Gross weight kg 198

# Warning

Please read this instruction carefully before using this equipment.

Please keep this manual properly for future reference.

Due to the need for continuous improvement, the actual product is slightly different from the product described here.

## ***1. Ready to begin***

A. the power supply line, the sheath line (three power lines, one zero line, one ground wire) line, one ground wire) is selected, the power line is required to be more than 2.5 square millimeters, and the cleaning machine must be ground wire to avoid electric shock.

B. pipe diameter please choose 10mm, the quota pressure value should be greater than 125 PSI, and install the intake pressure regulating valve, the pressure is adjusted to 6 BAR (87PSI). Install intake switches for maintenance of airways.

## ***2. Pre-operational inspection***

A. check the fittings pipeline water tank and so on is damaged.

B. check if the sealing strip inside the working room box is broken, the machine can only be operated when all doors are closed and the exhaust system is running.

C. check that the protective gloves are in good condition

## ***3. Safety Warning in Use***

A. the door is closed to open the pump, when the pump is closed to open the door.

B. should wear protective gloves when starting work, water spray muzzle should be away from gloves, minimum distance should be kept above 10 CM. lest the muzzle be too close to the protective gloves and break through the protective gloves.

## ***4. Caution***

A. Pay attention to silicosis, do not use media containing free silica.

B. Unless specified, the pressure of the cleaning machine shall not exceed 100 BAR, keep the spray gun port aiming at the workpiece.

## ***5. Maintenance***

Keep the machine in good repair condition, use the original parts, do not replace or modify the original parts.

## ***Important reminder***

To distributors, purchasers and end users using this product.

sandblasting equipment and consumables (products) described and described in this material are suitable for experienced and knowledgeable users.

The products described in this material are determined separately by the user in various ways and purposes. However, not for intended use, performance standards, engineering applicability, safety practices or compliance with these products, other products or third party products shall comply with local government laws and regulations, and various products shall be selected by the user or others. Users of these products and third-party products, as well as users of various product combinations, have a duty to use them with caution and to be familiar with all locally applicable government laws, regulations and safety requirements.

Also does not represent any other product portfolio reference, product service life or maintenance performance.

This material shall not be used for estimation purposes. Only responsibility or user based on user's expertise, experience and industry variable knowledge, productivity, labor performance or surface treatment.

It is the responsibility of users to ensure that operators are properly trained and comply with relevant local laws and regulations, environment and safety precautions.

We provide a variety of quality products for the surface treatment industry, and we believe that all elite users, operators and contractors in the industry will continue to use our products in a safe manner.

## ***Installation instructions***

- 1.To connect the power line, it is required to close the power source switch, connect the 380 V three-phase power line UVW to the UVW ground wire pile of the connection row, connect the zero line to the N ground wire pile of the connection row, and connect the protective ground wire to the protective ground wire pile of the connection row
- 2.Connect the gas source, select the 10 diameter pipe to the intake source three-way joint. Adjust intake pressure PSI.85
- 3.Open the oil port respirator bolt on the pump crankcase and add the engine oil to the oil mark line.

Reference Type:

Castrol Professional 5W-40

Mobil 5W-40 4L API SN

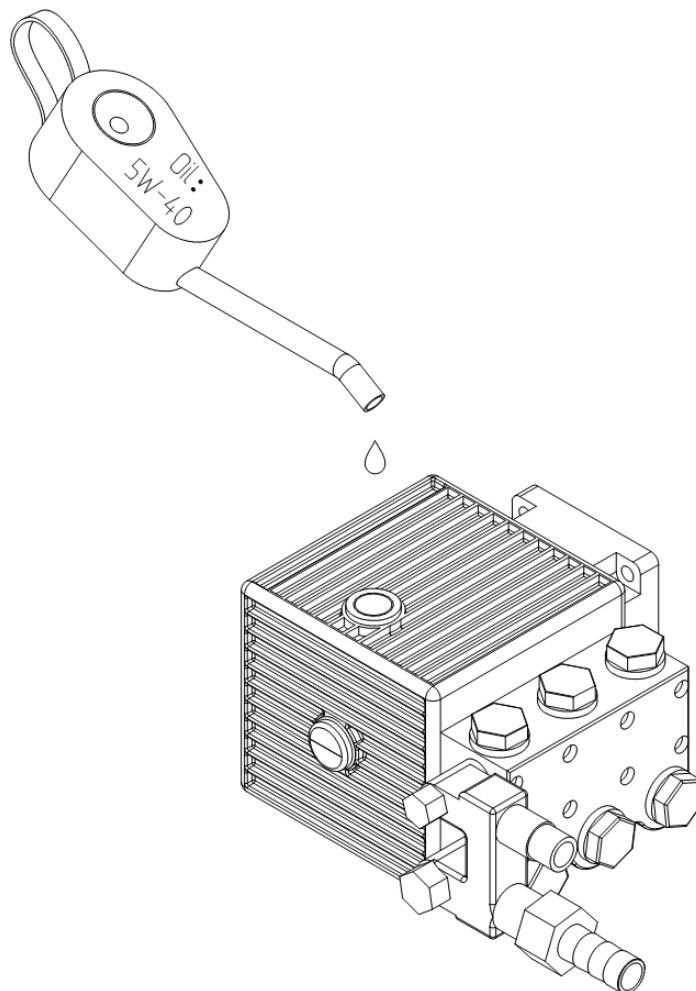

- 4.Add water to refuel sewage cleaning agent, dilution ratio according to the oil cleaning agent on the description of the proportion configuration. Water tank cleaning liquid required monthly replacement, the

use of ordinary cleaning liquid dirty also need to be replaced.

5.The oil filter paper is cushioned on the water tank diode filter box. When the filter is used for more than 10 hours or dirty, the oil filter paper should be replaced.

6.The working pressure of the high pressure pump can be adjusted to 150 when the stubborn dirt on the parts and the deeper rust spray can not be cleaned. Turn the red knob on the high pressure pump clockwise to increase the pressure of the pump, otherwise reduce the pressure of the pump), the maximum can be adjusted to 200 KG/cm. When the pressure is adjusted to 200 KG/cm, the working time of the high pressure pump can not exceed 10 minutes (long time use will cause the pressure of the high pressure pump to reduce or smooth), after cleaning, the working pressure of the high pressure pump can be adjusted back to 100 KG/cm, to ensure the service life of the pump.

7. Adjustment of temperature control for cleaning night heating

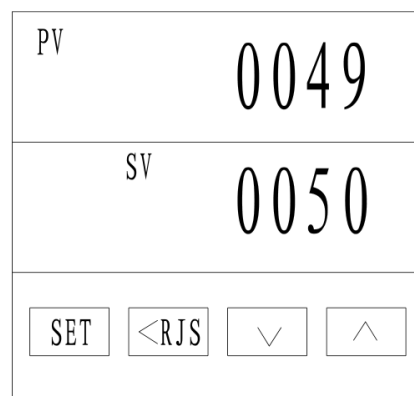

S V Setting temperature   P V Measured temperature

Press SET- press up and down key to adjust the set temperature and then press SET key to exit the temperature setting, the temperature is set to 50 degrees, the maximum set temperature must not exceed 60 degrees (setting too high will cause damage to the pump seal key).

8 .boot sequence: turn on the power switch, first wait for the temperature knob to heat, wait for the cleaning liquid temperature to reach the set temperature, press the high-pressure pump start button, you can pull the gun trigger to clean the parts.

Machine Explosion Drawing and Parts List

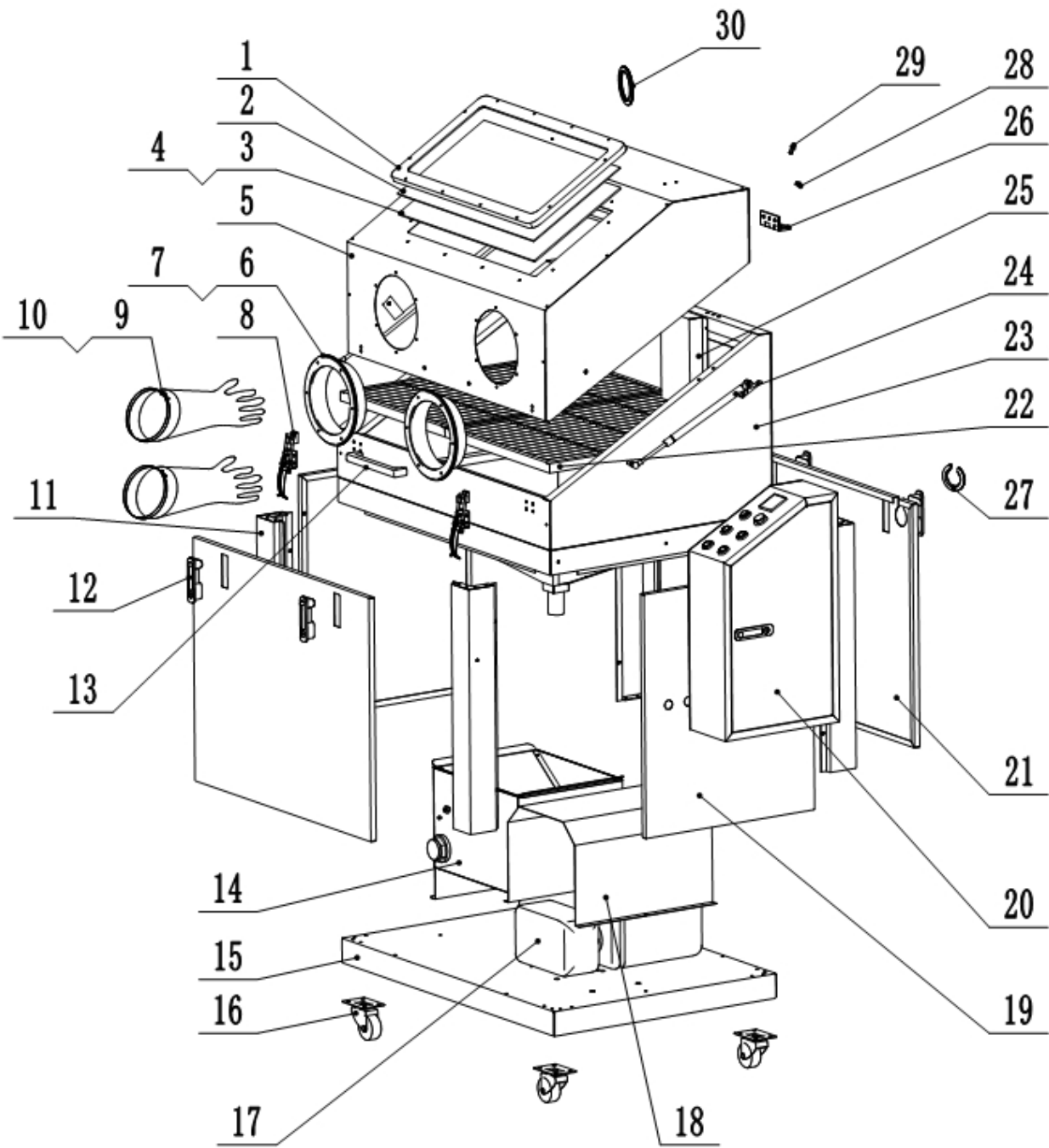

Number	Name	QTY
1	Press border	1
2	Organic glass window	1
3	White glass	1
4	Protective film	4
5	Upper flip assembly	1
6	Sealing gasket	2
7	Glove seat	2
8	Stainless steel box buckle	2
9	Protective gloves	2
10	Hoop o170-190	2
11	Column Assembly Chart	4
12	Door lock	4
13	Handle(L=200)	1
14	Water tank assembly diagram	1
15	Floor Assembly Diagram	1
16	Universal wheel	4
17	Motor Pump Assembly	1
18	Motor cover	1
19	Side door plate	2
20	Electric Control Box Assembly Diagram	1
21	Front and rear door plates	2
22	Leakage plate	2
23	Assembly drawing of box assembly	1
24	Air spring	2
25	Air suction hood assembly	1
26	Hinge	2
27	Small sealant ring	1
28	Hexagon lock nut W8 for type 1 metal insert	12
29	Hexagon Flat Head Screw M8X16	12
30	Air vent seal	1

Explosive Chart and Parts List of Water Cycle System

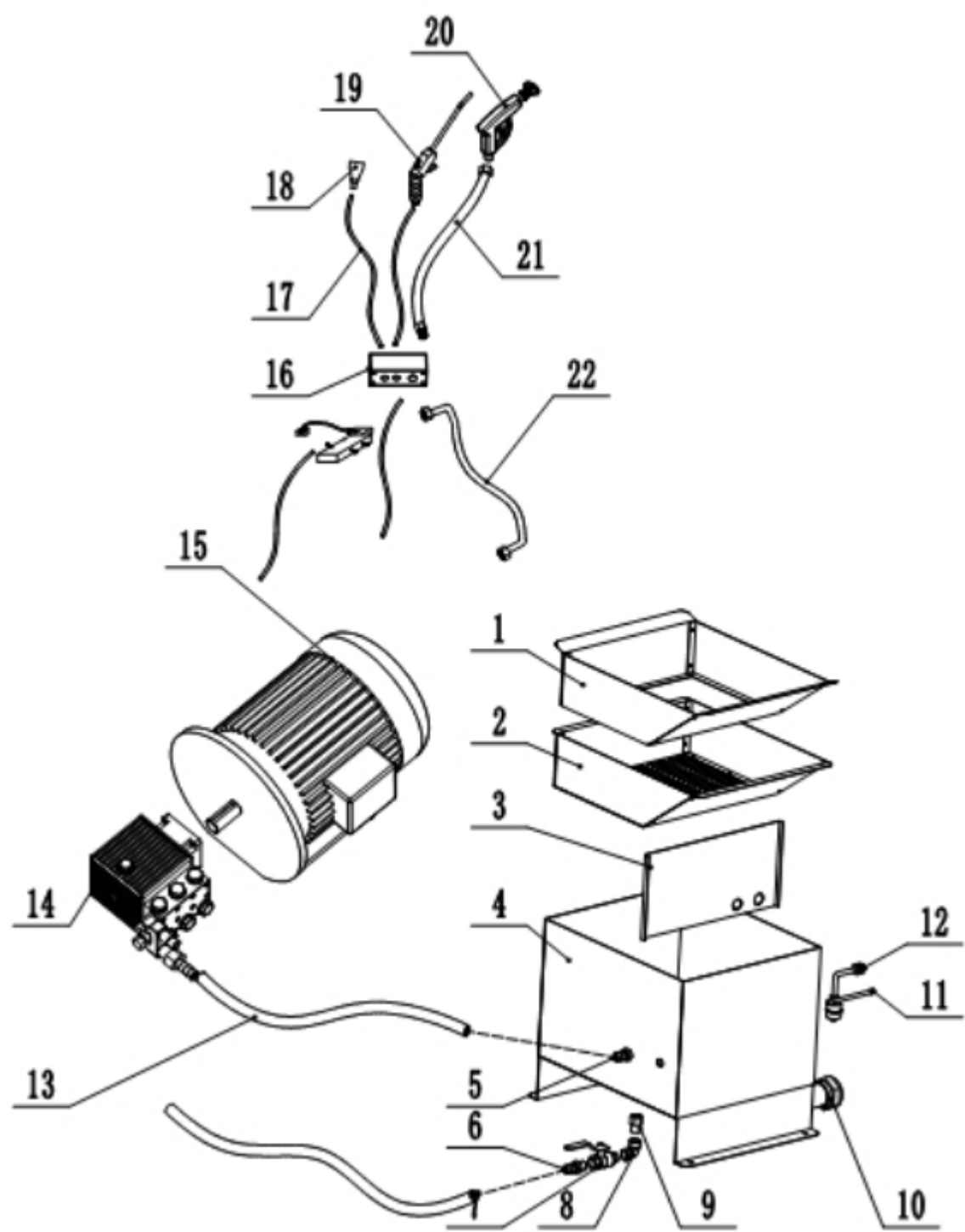

Number	Name	QTY
1	press frame ring	1
2	Filter frame assembly	1
3	baffle	1
4	Water tank assembly diagram	1
5	Hot water joint	1
6	Water input hose joint	1
7	3/8' inner and outer ball leap	1
8	3/8' right-angle enemy junction	1
9	Water outlet joint	1
10	Heating tube	1
11	Thermostats	1
12	Water level detection switch	1
13	Steel wire spiral plastic	1
14	Pump	1
15	Motor	1
16	Turn in direction	1
17	Air hose	5
18	Air gun F1/4'	1
19	Blowing gun	1
20	High pressure water gun	1
21	Small size oil hose	1
22	Big size oil hose	1